

Plotted By: Fernandez, Giovanni. Sheet Set: MILLCREEK POMPANO. Layout: C-600 PHOTOMETRICS PLAN. November 21, 2025. 04:07:22pm. K:\FTL\_Civil\043 jobs\043175014 Mill Creek Pompano\Design\CADD\Plan\Sheets\C-600.dwg  
This document, together with the concepts and designs presented herein, is an instrument of service, as an instrument of service, as intended only for the specific purpose and client for which it was prepared. Reuse of and improper reliance on this document without written authorization and adaptation by Kintley-Horn and Associates, Inc. shall be without liability to Kintley-Horn and Associates, Inc.

NANCY WATERWAY  
70' CANAL RIGHT-OF-WAY

R W A Y

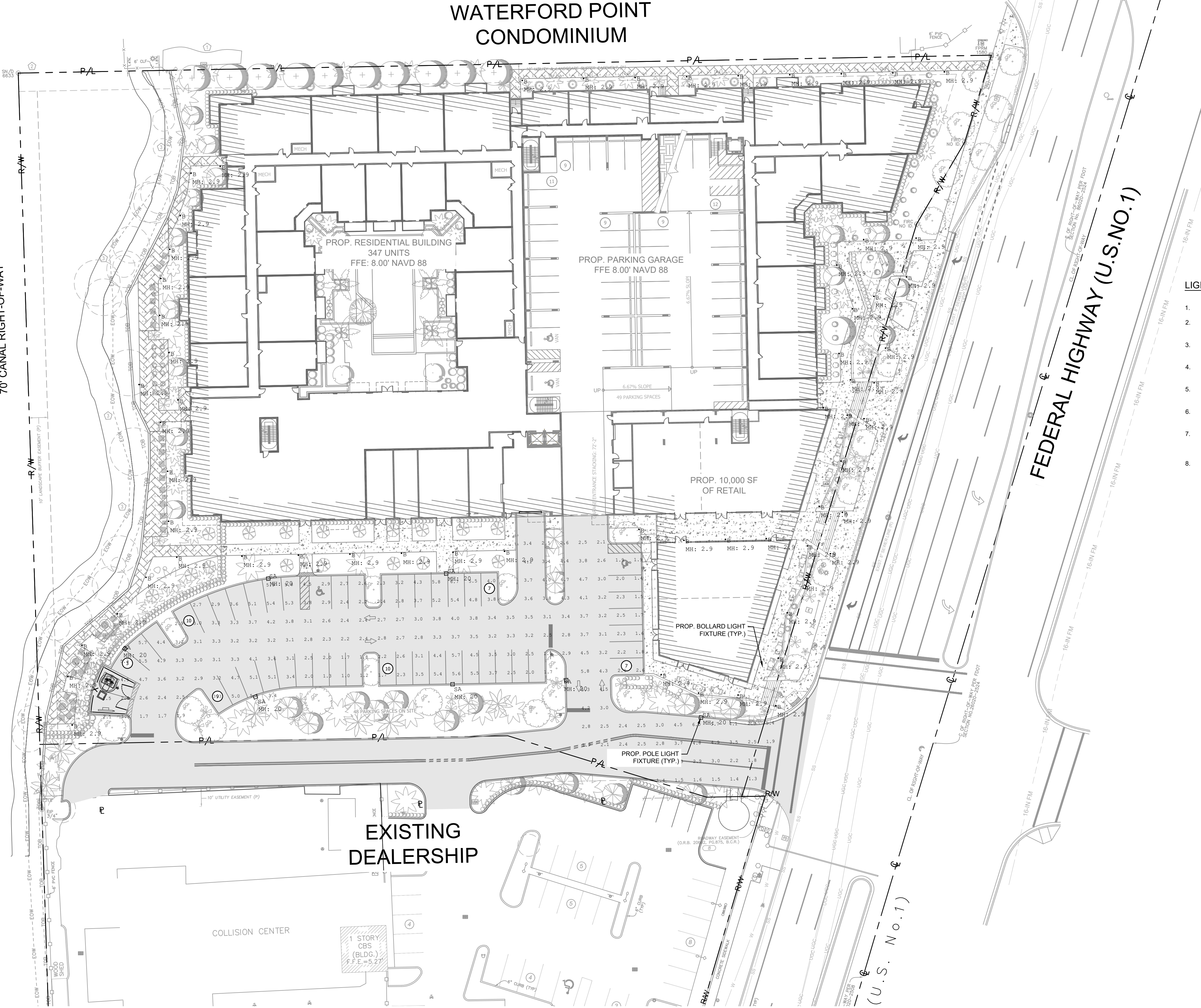

Calculation Summary									
Label	CalcType	Units	Avg	Max	Min	Avg/Min	Max/Min		
Front Sidewalk	Illuminance	Fc	3.46	7.5	1.0	3.46	7.50		
Parking Lot	Illuminance	Fc	3.26	6.7	1.0	3.26	6.70		
Property Line	Illuminance	Fc	0.76	1.9	0.0	N.A.	N.A.		
Rear Sidewalk	Illuminance	Fc	3.00	4.9	1.1	2.73	4.45		
Sidewalk	Illuminance	Fc	2.54	3.4	1.1	2.31	3.09		

Luminaire Schedule									
Symbol	Qty	Label	Arrangement	Description	LLF	Luminaire Lumens	Luminaire Watts	Total Watts	
⊙	62	B	Single	PIL INDEX+-360-18W-XX-XX-UNV-XX	0.900	2120	17	1054	
7	7	SA	Single	Xtra Light VNTS-18000L-XX-DIM-4M-N-XX-XX-HSS	0.900	12006	129	903	
1	1	SB	Single	Xtra Light VNTS-18000L-40K-DIM-5S-N-XX-XX	0.900	18189	128.7	128.7	

LEGEND:

- P/L — R/W — PROPERTY LINE AND/OR RIGHT-OF-WAY
- ⊕ PROPOSED LIGHT POLE
- 2.6 CALCULATION POINT

LIGHTING NOTES:

- ALL WORK AND MATERIALS SHALL COMPLY WITH ALL CITY/COUNTY/STATE REGULATION AND CODES.
- CALCULATED VALUES ARE DERIVED THROUGH A COMPUTER BASED MODEL WITH LIGHT FIXTURE DATA AS SUPPLIED BY MANUFACTURER THROUGH IES FILES.
- ANY DEVIATION FROM SPECIFIED FIXTURE MODELS AND MOUNTING HEIGHTS IN THIS EXHIBIT WILL DISCOUNT THE VALIDITY OF THESE CALCULATIONS.
- THE PHOTOMETRIC ANALYSIS EXCLUDES ALL PROPOSED OFF-SITE STREET LIGHTING, PROPOSED LANDSCAPE LIGHTING, AND EXISTING OFF-SITE LIGHTING.
- ALL LUMINAIRE SYMBOLS ARE DIAGRAMMATIC ONLY. CONTRACTOR TO FIELD COORDINATE EXACT LOCATIONS AND SETBACKS AGAINST UNDERGROUND UTILITY AND OTHER OBSTRUCTIONS.
- CONTRACTOR TO FIELD VERIFY FIXTURE VOLTAGE AND FINISH WITH OWNER AND ARCHITECT PRIOR TO PURCHASE AND INSTALLATION.
- LIGHT FIXTURES SHALL BE FULLY INTEGRATED WITH INTERIOR LIGHTING SYSTEM. PROVIDE FULLY COMPATIBLE SYSTEM THAT INCLUDES TIMECLOCK OPERATION, INTEGRAL OCCUPANCY SENSING, REMOTE ACCESS AND CONTROL FOR ADJUSTMENT OF HIGH/LOW TRIMMING, ZONING, ETC.
- CONTRACTOR SHALL ENSURE PROPER EROSION CONTROL IS IN PLACE PRIOR TO DEMOLITION.

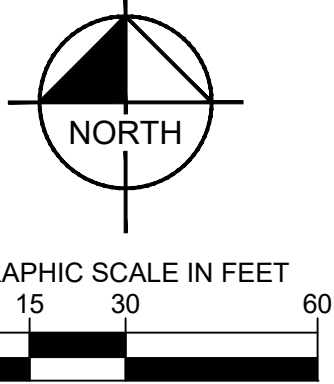

Kimley»Horn

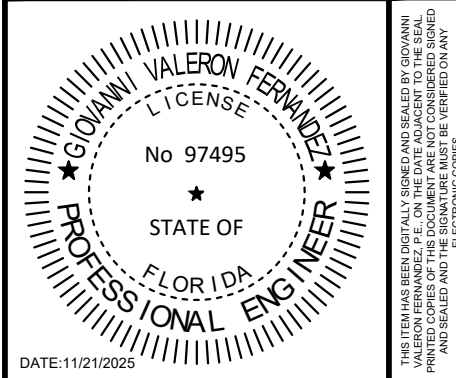

KHA PROJECT	043175014
DATE	11/02/2025
SCALE	AS SHOWN
DESIGNED BY	GVF
DRAWN BY	EA
CHECKED BY	GVF

PHOTOMETRICS  
PLAN

MODERA POMPANO  
BEACH  
PREPARED FOR  
MCRT INVESTMENTS LLC  
FLORIDA

SHEET NUMBER  
C-600

NO.	REVISIONS	DATE	BY